

User Manual

AutoSwitch

ΔTIZ

Introducing the new AutoSwitch

What it does?

Instead of having to press a scan button every time you turn a page, the AutoSwitch will trigger the cameras to shoot the pages automatically every time the page is turned.

It can save you millions of manual button pressing!

What's new about the new model?

- This 2nd generation AutoSwitch has been reengineered for improved performance. It has an optical sensor that will not interfere with the operation or the movement of the glass platen, making for a smoother scanning experience.

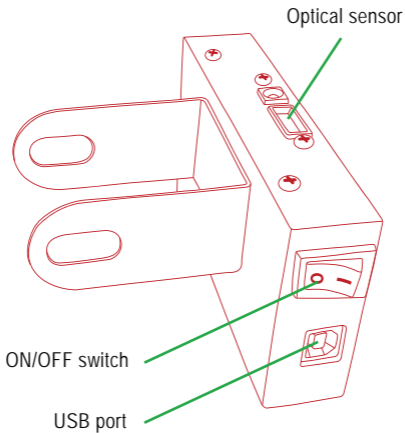

- The unit is made more compact and more reliable.
- It also integrates an ON/OFF switch so it can be quickly turned off when not in use.

How to install

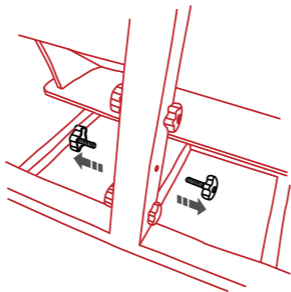

1. Remove the middle knobs (front and rear) from the legs of BookDrive DIY.

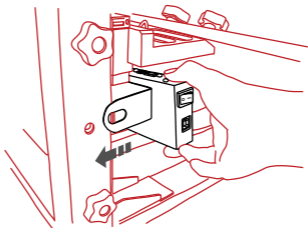

2. Put the AutoSwitch in place of the middle knobs instead.

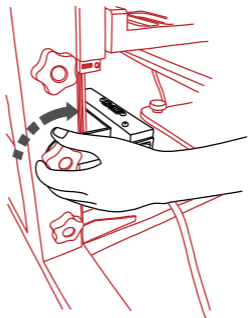

3. Lock the knobs.

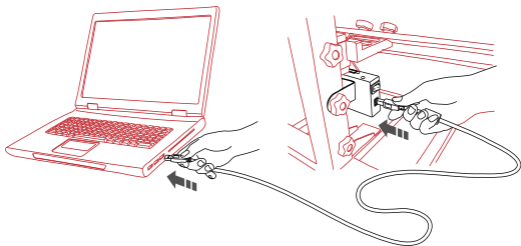

4. Plug the USB cable to the AutoSwitch port and to the computer port.

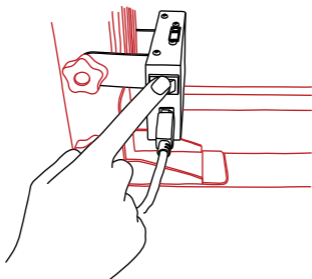

5. Turn on the switch when you want to use.

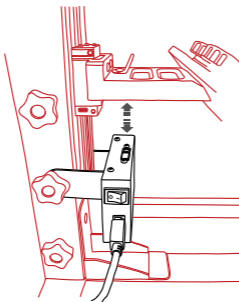

6. Scan a book as you would normally do, the AutoSwitch will trigger the cameras to shoot when the page is turned.

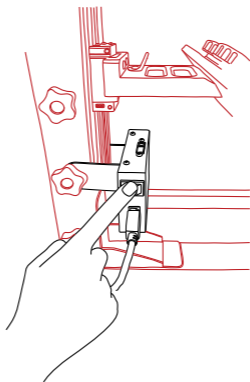

7. Turn off the switch whenever you want to disable it.

Feel free to contact support@atiz.com if you have any questions.

Happy scanning!

